

SHUFFLE

Anchoring NAM

Installation instructions



- 1**  The components contained in these modules shall only be replaced by the manufacturer or his service agent or a similar qualified person. Always switch off the power prior to installation, maintenance or repair activities.

2 Included hardware

4x - Anchor bolt
3/4-10 X 17 X 3
Hook

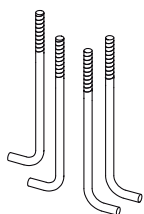

1x Wood template

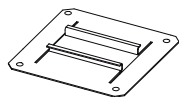

8x - 8x - Flat washer
0.81 ID X 2.0 OD X .13 thick



8x - Hex nut 3/4 X 10



3

Template dimensions

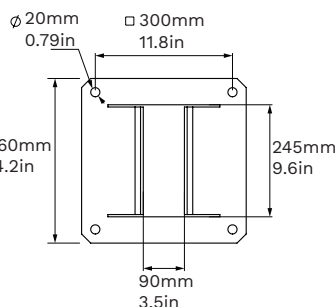

Pole flange dimensions

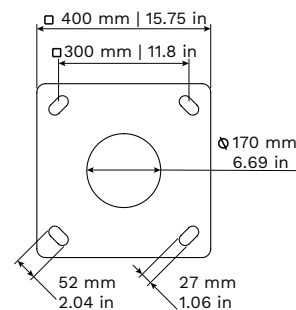

Installation procedure

- 4** Prepare footing as required by local codes.
Prepare the necessary cabling.

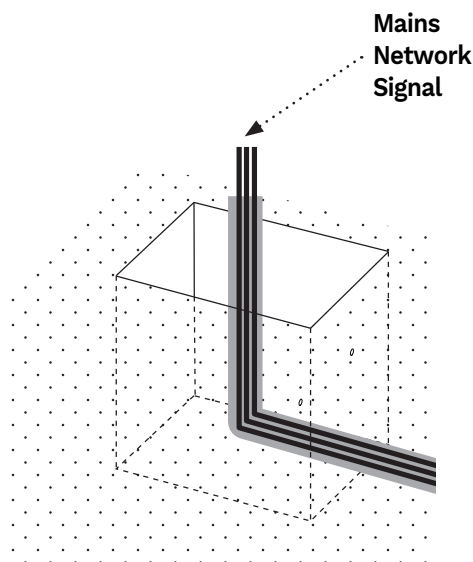

- 5** Mount the anchor bolts on the supplied jig.
(jig mounting method defined by installer)
Leave threaded extremity above the jig.
The extremity length depends on the type of installation and how the finishing is defined.
It should have enough space for 3/4 X 10 hex nuts, washers and tool for tightening.

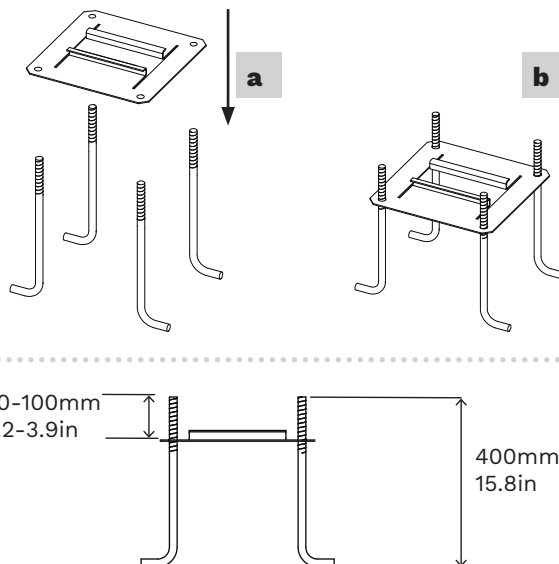



Landscape Forms is not responsible for site preparation and footings. The following chart gives necessary information for calculating proper footing size, depending on the specified light pole.

WARNING: Pole mounted luminaires must be attached either before or immediately after pole installation. Failure to do so may cause vibration damage to the pole and will void the pole warranty.

Overall height (ft)	Wind Speed (MPH at 1.3 Gust) calculated using 2015 AASHTO standards	Base Overtuning Moment (ft-lbf)	Bear Shear (lbf)
19	170	4600	477
22	170	6500	569

- 7** Place the jig with the anchor bolts inside the concrete moulding leaving threaded extremity out.

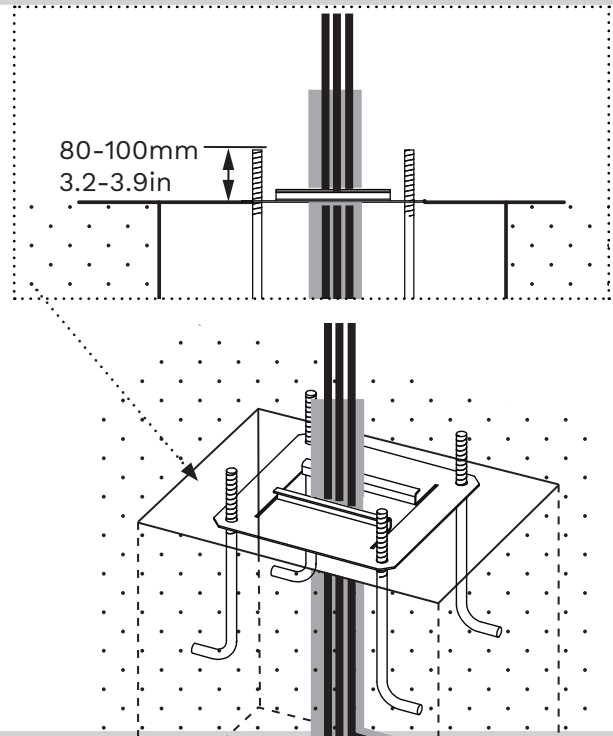
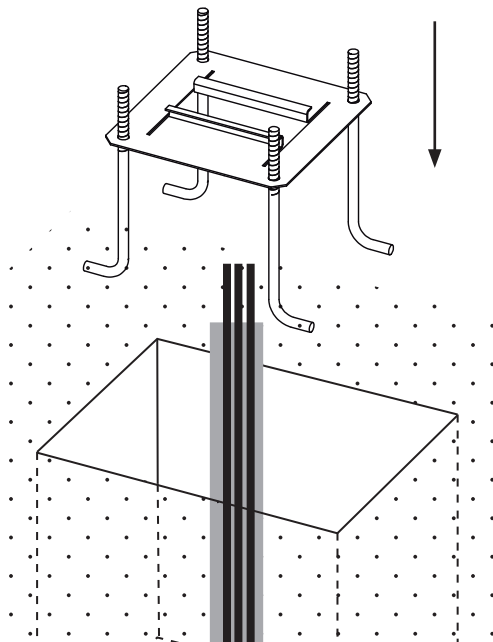

- 8** Fill the moulding with concrete

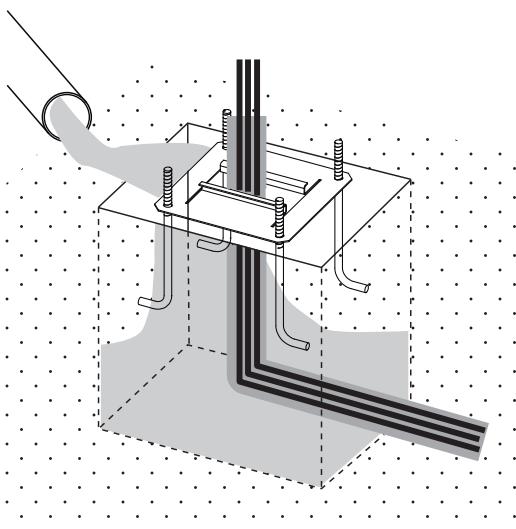

- 9** After concrete curing, remove jig.

