

Included components

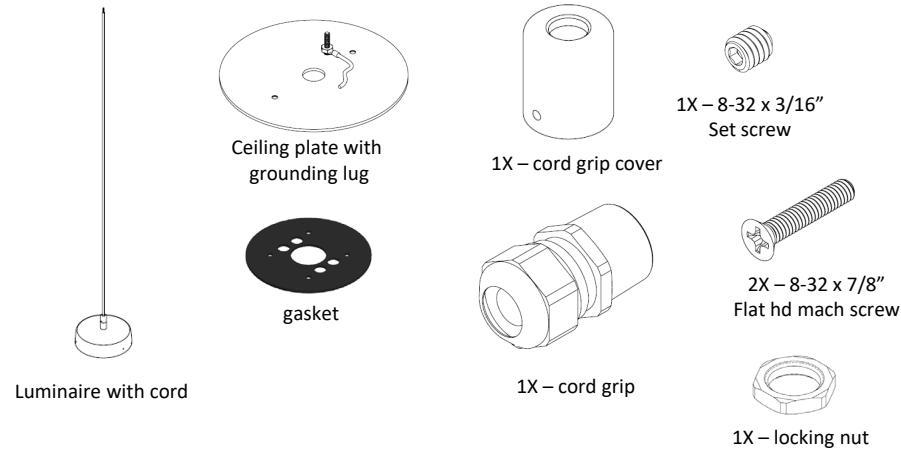

Tools Required

- Safety glasses
- 5/64", 3/32" and 3/16" hex keys
- Wiring tools and connectors
- Phillips screwdriver
- Standard 4in octagon junction box, installed (not included)

ASSEMBLE WITH CARE! Pangard II® Polyester Powdercoat is a strong, long-lasting finish. To protect this finish during assembly, place unwrapped powdercoated parts on packaging foam or other non-marring surface. Do not place or slide powdercoated parts on concrete or other hard or textured surface – this will damage the finish causing rust to occur. Use touch-up paint on any gouges in the finish caused by assembly tools.

INSTALLATION PROCEDURE:

Landscape Forms is not responsible for site preparation.

Note: The pendant mount plate is designed to work with a standard 4in octagon junction box, supplied by installer. The outside face of the box should be flush or slightly recessed with the ceiling.

1. Determine overall drop of fixture. Included 18/3 SOOW cord is 72in long. Cut exposed end of cord as needed, leaving an additional min. 4" length for wiring connections at junction box.
2. Slide components over cord as shown in Fig. 1. Tighten cord grip in position on the cable, tighten locking nut.
3. Attach cord grip cover using (1) 8-32 x 3/16" set screw.
4. Make wiring connections in junction box according to local codes. Grounding lug and pigtail are preassembled to the ceiling mount plate.
5. Attach plate to junction box using two 8-32 x 7/8" flat head machine screws, included. Add silicone if necessary to seal gasket to ceiling.
6. **Note:** luminaire ships assembled. To reduce weight of fixture during installation, the luminaire cartridge can be temporarily removed. To remove luminaire cartridge, see Fig. 2. Back out three set screws to loosen dome. Disconnect the wiring harness plug. Set cartridge aside. Do not fully back out set screws from dome.
7. Reattach fixture to dome after mounting is complete. Reattach wiring harness plug. Align set screws with the holes in the cartridge and tighten evenly. Gently lift the dome while threading in the set screws to check for proper engagement of threads.

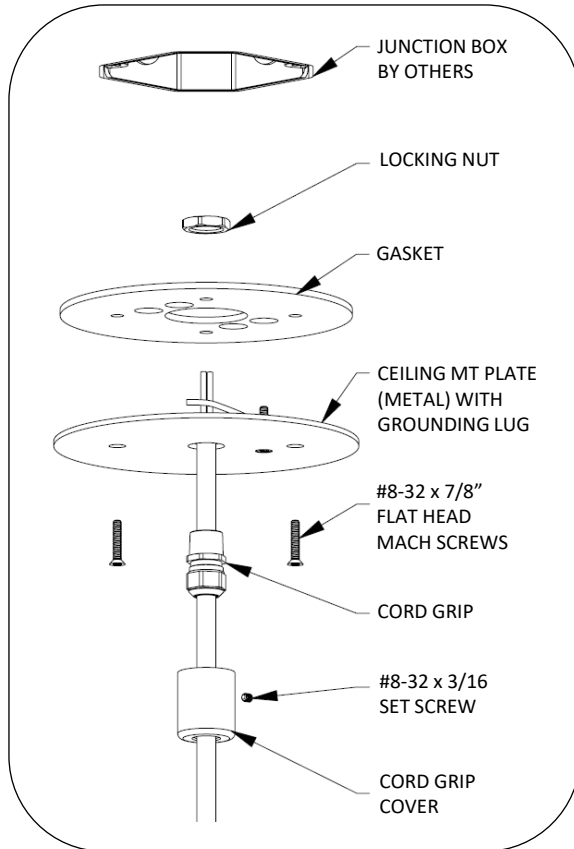

Fig. 1 – secure mt plate and gasket to junction box

PROCEDURE FOR WIRING:

The Motive pendant mount luminaire is assembled at the factory. The light cartridge is mounted into the body of the luminaire and will not need to be removed during installation. The LED cartridge is wired to the driver at the factory. Use of LED drivers other than the supplied unit is not recommended and will void the warranty.

Connection hardware not included.

Installers are responsible for line-in connections.

Optional dimming control is not included.

WARNING!: LED cartridge and driver are not rated for connection or disconnection while energized. Doing so may damage LEDs and will void the warranty. Disconnect incoming power before making or breaking any electrical connections.

Note: This unit is pre-wired.

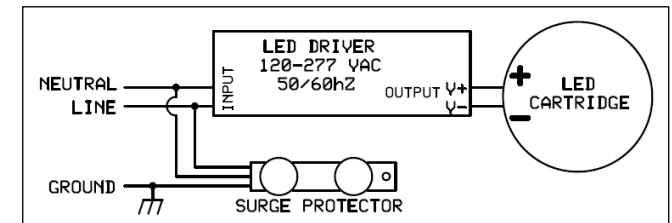

Fig. 3 – wiring diagram

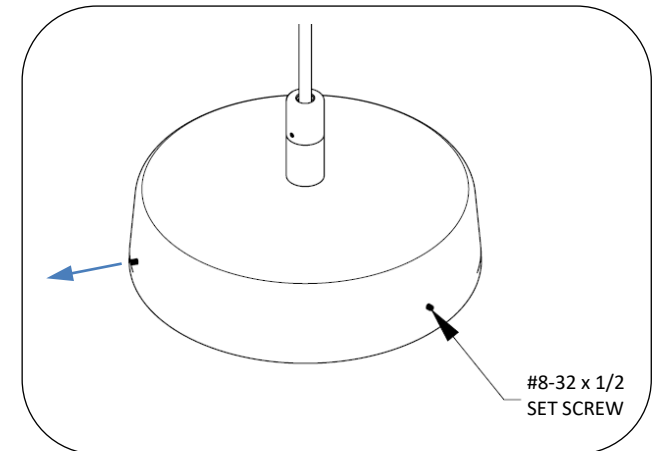

Fig. 2 – back out set screws